

# WAOK

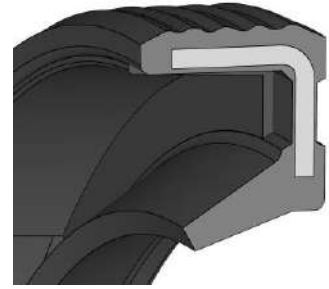

Rotary shaft seal in standard design with a grooved elastomer outer sheath covering a metal insert without an energised spring on the sealing lip.

## DESCRIPTION

**Product group:** Rotary shaft seal

**Design:** A = outer surface rubber-coated

**Model:** OK = without spring and with grooved outer surface

**Seal material:** NBR 70

**Colour:** green

**Stiffening ring:** non-alloy steel acc. to DIN EN 10139

## MEDIA

Good chemical resistance to various mineral oils and greases.

## AREAS OF APPLICATION

Secondary sealing e.g., as a dust, dirt or spray protection seal in electric engines, as a grease retainer.

## FUNCTION

The WAOK are single-action rotary shaft seals for rotating or pivoting shafts. The sealing lip design without a spring produces less friction. As a result, the sealing action in comparison to rotary shaft seals with energised springs is reduced. The elastomer outer sheath provides good static sealing, good thermal expansion balance e.g., in light-metal housings, better sealing with greater roughness and secure sealing for split housings as well as good static sealing with thin fluid or gaseous media.

## OPERATIONAL APPLICATION LIMITS

Pressure (MPa/bar): 0/0

Temperature (°C): -40 to +80 (short term +100)

Peripheral speed (m/s): < 6

The above-mentioned operating parameters are maximum values and may not occur simultaneously. Each is dependent on the other operating parameters.

## INSTALLATION

Suitable tools should be used for installation. It is recommended that the installation housing is designed to provide the rotary shaft seal with axial support.

## REMARKS

The nominal widths mentioned on the following pages represent the standard dimensions. They are generally in stock or can be delivered at short notice.

Other dimensions and different designs, e.g., double dust protection lip, spiral on the sealing lip, springs or metal inserts made of other steel grades can be produced as well as all kinds of special designs. Minimum quantities may be obligatory for dimensions outside of the standard.

